

Order form

Glassroof

ORDER: enquiries@prefixsystems.co.uk

QUOTE e: quotes@prefixsystems.co.uk

ACCOUNT No

Company Name

Order Number

JOB REFERENCE

Installer Company Name

Company Contact

Telephone No

Email

Delivery Address

PLAN VIEW

FRONT ELEVATION

POSTCODE

Delivery Date Req

Quotation Ref

CRITICAL INFORMATION

*Required for structural snow / wind loading

*Site Postcode

Roof Pitch (°)

Roof height restriction

Frame width

How to place an order for a Glass Roof

LEFT ELEVATION

RIGHT ELEVATION

1. Fill in above information and sketch plan and elevations showing position and dimensions of walls, brick piers, windows, doors, cut outs and intrusions. If necessary, attach photos of existing property.

2. Advise of the preferred position of any roof vents, rainwater pipes (RWP), tie bars and any additional information that may assist in specifying your order. If a Goalpost is needed, please complete page 3 of this order form.

3. A confirmation drawing will be created using our bespoke software and sent to you via email for you to check and sign. This will start the manufacture process. A delivery date will be emailed back as soon as it is scheduled.

In order to pass building regulations, all conservatory over 2.5m wide will need a glass U-value of at least 1.2. Smaller conservatories will need glass to be specified with 1.0 U-value. The thermal design guide within UDesign will provide the specific U-Value of each glass roof.

If you have any questions, queries or concerns please feel free to contact us on 01254 871800 or email us on enquiries@prefixsystems.co.uk and we will help any way we can.

Order form

JOB REFERENCE

ROOF COLOUR	White	Deeplas	Grained Grey	Smooth Grey	Mahogany	Light Oak	Rosewood	Black	Bespoke RAL/BS Colour
External	<input type="checkbox"/>	<input type="checkbox"/>	<input type="checkbox"/>	<input type="checkbox"/>	<input type="checkbox"/>	<input type="checkbox"/>	<input type="checkbox"/>		
Internal	<input type="checkbox"/>	<input type="checkbox"/>	<input type="checkbox"/>	<input type="checkbox"/>	<input type="checkbox"/>	<input type="checkbox"/>	<input type="checkbox"/>		

INTERNAL PELMET (when internal pelmet specified)

☐ 300mm ☐ Other (300-1200mm)

Please State (mm):

☐ On Fascia ☐ Below Fascia

If fitting to a bungalow please indicate Soffit Depth

CORNICE

Style ☐ 1 Tier ☐ 2 Tier ☐ 3 Tier ☐ Curved
Colour ☐ White ☐ Matt Grey ☐ Deeplas ☐ RAL/BS Colour

RIDGE

☐ Classic Ridge
☐ Slimline Ridge (ONLY on 25° georgian roof)

TOP CAPPINGS

☐ Dome (PVCu) Aluminium
☐ Bevel (PVCu) Square Aluminium
(Mono pitch lean-tos only in grey or white)

STRUCTURAL SUPPORT

☐ Structural (SEB) Eaves Bolstered Eaves Goalpost

Show openings on roof drawings on page 1.
Please refer to page 1 of the order form and complete elevation drawings if there are openings over 1800mm.

If Goalpost required- complete page 3

DOWNPIPE

☐ Round
☐ Square

CONSERVAFLASH

☐ Yes
Eaves flow (eaves beam trickle ventilation)

BOX GUTTER OPTIONS:

☐ 165mm 165mm Chambered
☐ 265mm Reinforced Box Gutter
Other, please state:

GLASS OPTIONS - WARM EDGE SPACER

Super Energy Saving Glass

Low Solar Gain	Medium Solar Gain	High Solar Gain
<input type="checkbox"/> Ultimate Blue Aqua 4S	<input type="checkbox"/> Bronze 4S Blue 4S Neutral 4S	Clear 4S

Good Thermal Efficiency

Low Solar Gain	Medium Solar Gain	High Solar Gain
<input type="checkbox"/> Std Aqua	<input type="checkbox"/> Std Bronze Std Blue Std Neutral	Std Clear

POLYCARBONATE

Size ☐ 25mm 35mm
Colour ☐ Clear Opal ☐ Bronze Bronze / Opal Heatguard / Opal

UNGLAZED

Polycarb ☐ 25mm ☐ 35mm
Glass ☐ 24mm

ROTABOND SEALANT - MS POLYMER

☐ Black Tubes (NCGS001B)

ROOF VENTS AND MECHANISM (mark plan)

Roof vent up to ridge Roof vent with glass above

Brass ☐ Manual Spindle Manual Spindle and pole ☐ Manual Spindle and telescopic pole
Chrome ☐ Manual Spindle Manual Spindle and pole

☐ Electric motor with digital thermostat and rain sensor ☐ Electric motor and rocker switch
☐ Electric motor with radio and remote control ☐ Electric motor with thermostat (AVTD002)
☐ Electric without switch/thermostat (Motor only)

DECORATION

Cresting Renaissance Tudor Elizabethan Baroque Classic Low profile Aluminium
Finial Pikestaff Sceptre Ball Coronet Classic Low profile Aluminium

ANCILLARY EXTRAS

Please refer to the Classic Technical Guide.

Goalpost specification

Glassroof

By Ultraframe

Goalpost Colour

To match roof internals

Bespoke:- RAL colour

Leg length

Frame height

Length below floor/cill

Goalpost leg example

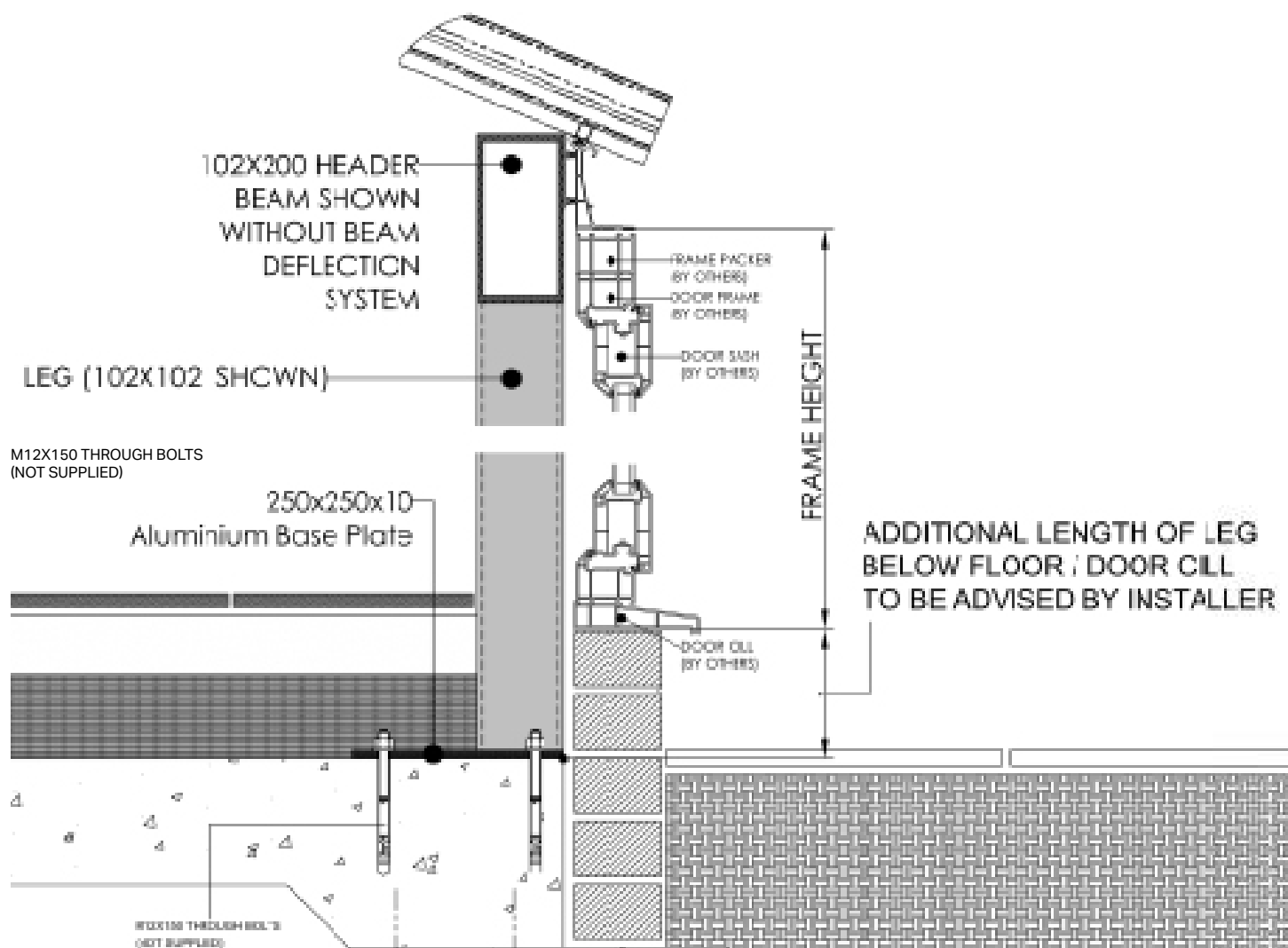

Disclaimer:

Ultraframe does not take responsibility for the structural stability of the entire structure, only the products provided by Ultraframe. To ensure the rest of the structure is suitable, it is the installers responsibility to ensure that all walls, foundations and building structure are compliant with Document A of Building Regulations. Any adjoining window frames must be a minimum of 70mm reinforced PVC frames, coupled in accordance with the manufacturer's recommendations. Host walls must be suitable to take the additional load and forces of the new building.

All beam end plates (WP and SP) must be bolted to a suitable substrate with adequate anchors. For the WP, the host wall suitability to accept the increased forces must be checked. The SP should be positioned on a suitable concrete padstone built into the supporting wall and strapped down to at least two additional courses.

Baseplates must be anchored using a minimum of 3no. M12 through bolts (minimum 6kN Tension/Uplift capacity per bolt). Foundations or floor slabs must be designed to accept the additional forces.